

BRACO CW TYPE GLANDS

Braco CW Brass cable glands are as per BS 6121 Part 1 and suitable for single wire armoured plastic or rubber sheathed cables. The outer seal grips sheath. These glands provide mechanical cable retention, and electrical continuity via armour wire termination. The use of these glands is recommended in indoor as well as outdoor application because of suitability in most climatic conditions, weather proof and water proof.

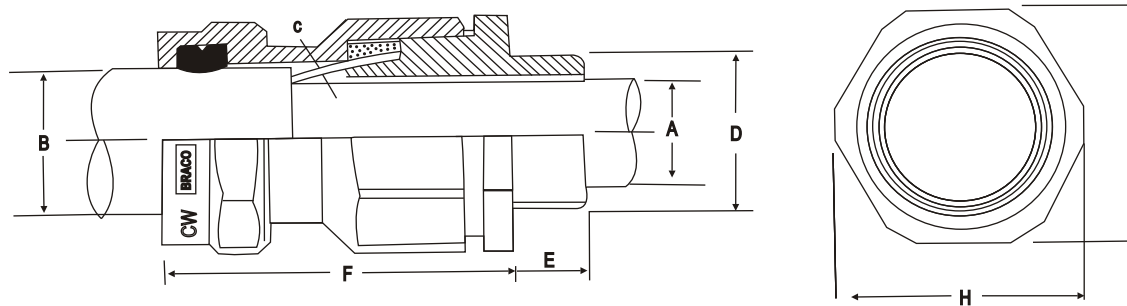

Cat No.	Cable Dimensions Accomodated (mm)			Gland Dimensions (mm)					
	Under Armour A Max	Overall B Min Max		Armour Wire Dia C	Iso Entry Thread D E		Appx. Length From Shoulder F	Hexagon Size A/F (G) A/C (H)	
CW 20S	11.6	8.0	15.8	0.9/1.25	20	10	46	25.7	29.2
CW 20L	13.9	11.7	20.8	0.9/1.25	20	10	46	30.5	34.0
CW 25	19.9	17.0	27.2	1.25/1.6	25	10	51	37.6	42.2
CW 32	26.2	23.5	33.5	1.6/2.0	32	10	56	47.3	53.6
CW 40	32.1	29.0	39.9	1.6/2.0	40	15	59	56.4	61.5
CW 50	44.0	39.5	52.6	2.0/2.5	50	15	64	70.1	77.2
CW 63	55.9	51.3	65.3	2.5	63	15	67	80.0	87.4
CW 75	67.9	62.5	78.0	2.5	75	15	76	98.0	109.2
CW 85	74.0	68.0	88.0	3.15	85	20	110	98.8	126.0

